

1. All work shall be done in accordance with the specifications of the City of San Bernardino, California, Department of Public Works, Division of Engineering, and the specifications of the California Department of Transportation, Division of Highways, and the specifications of the California Department of Transportation, Division of State Routes.

2. All work shall be done in accordance with the specifications of the City of San Bernardino, California, Department of Public Works, Division of Engineering, and the specifications of the California Department of Transportation, Division of Highways, and the specifications of the California Department of Transportation, Division of State Routes.

3. All work shall be done in accordance with the specifications of the City of San Bernardino, California, Department of Public Works, Division of Engineering, and the specifications of the California Department of Transportation, Division of Highways, and the specifications of the California Department of Transportation, Division of State Routes.

4. All work shall be done in accordance with the specifications of the City of San Bernardino, California, Department of Public Works, Division of Engineering, and the specifications of the California Department of Transportation, Division of Highways, and the specifications of the California Department of Transportation, Division of State Routes.

DESIGNED BY: [Signature]

CHECKED BY: [Signature]

DRAWN BY: [Signature]

DATE: [Date]

PROJECT NO.: [Number]

REFERENCE: [Number]

258

DEPARTMENT OF ENGINEERING
CITY OF SAN BERNARDINO
ARROWHEAD AVENUE
BETWEEN RIALTO AVENUE AND THIRD STREET


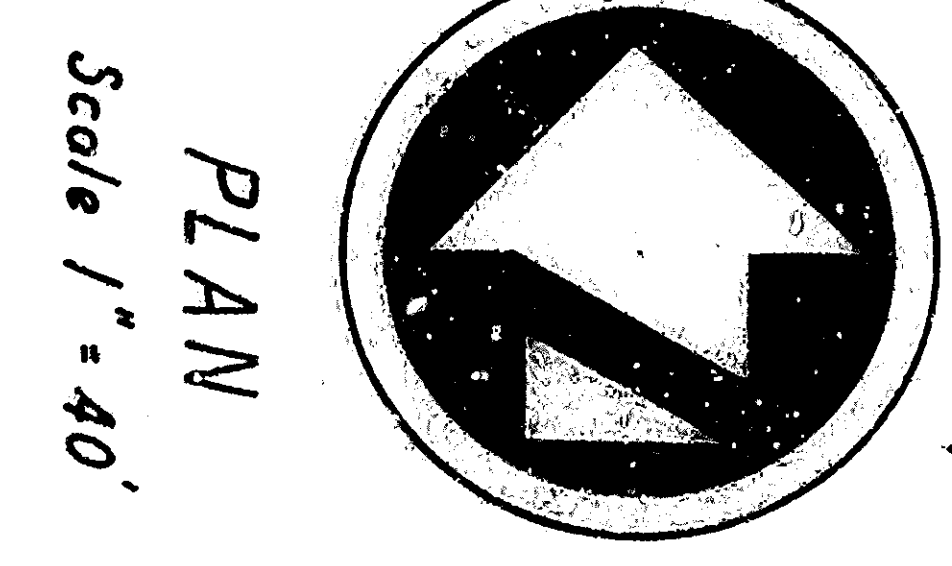


DEPARTMENT OF ENGINEERING
CITY OF SAN BERNARDINO
ARROWHEAD AVENUE
BETWEEN RIALTO AVENUE AND THIRD STREET

DESIGNED BY: [Signature]
CHECKED BY: [Signature]
DATE: [Date]

1. All work shown on these plans shall be done in accordance with applicable provisions of Standard Specifications for Highways, published August 1958.
2. Show from top to bottom: (a) grade, (b) curb, (c) gutter, (d) gutter, (e) gutter, (f) gutter, (g) gutter, (h) gutter, (i) gutter, (j) gutter, (k) gutter, (l) gutter, (m) gutter, (n) gutter, (o) gutter, (p) gutter, (q) gutter, (r) gutter, (s) gutter, (t) gutter, (u) gutter, (v) gutter, (w) gutter, (x) gutter, (y) gutter, (z) gutter, (aa) gutter, (ab) gutter, (ac) gutter, (ad) gutter, (ae) gutter, (af) gutter, (ag) gutter, (ah) gutter, (ai) gutter, (aj) gutter, (ak) gutter, (al) gutter, (am) gutter, (an) gutter, (ao) gutter, (ap) gutter, (aq) gutter, (ar) gutter, (as) gutter, (at) gutter, (au) gutter, (av) gutter, (aw) gutter, (ax) gutter, (ay) gutter, (az) gutter, (ba) gutter, (bb) gutter, (bc) gutter, (bd) gutter, (be) gutter, (bf) gutter, (bg) gutter, (bh) gutter, (bi) gutter, (bj) gutter, (bk) gutter, (bl) gutter, (bm) gutter, (bn) gutter, (bo) gutter, (bp) gutter, (bq) gutter, (br) gutter, (bs) gutter, (bt) gutter, (bu) gutter, (bv) gutter, (bw) gutter, (bx) gutter, (by) gutter, (bz) gutter, (ca) gutter, (cb) gutter, (cc) gutter, (cd) gutter, (ce) gutter, (cf) gutter, (cg) gutter, (ch) gutter, (ci) gutter, (cj) gutter, (ck) gutter, (cl) gutter, (cm) gutter, (cn) gutter, (co) gutter, (cp) gutter, (cq) gutter, (cr) gutter, (cs) gutter, (ct) gutter, (cu) gutter, (cv) gutter, (cw) gutter, (cx) gutter, (cy) gutter, (cz) gutter, (da) gutter, (db) gutter, (dc) gutter, (dd) gutter, (de) gutter, (df) gutter, (dg) gutter, (dh) gutter, (di) gutter, (dj) gutter, (dk) gutter, (dl) gutter, (dm) gutter, (dn) gutter, (do) gutter, (dp) gutter, (dq) gutter, (dr) gutter, (ds) gutter, (dt) gutter, (du) gutter, (dv) gutter, (dw) gutter, (dx) gutter, (dy) gutter, (dz) gutter, (ea) gutter, (eb) gutter, (ec) gutter, (ed) gutter, (ee) gutter, (ef) gutter, (eg) gutter, (eh) gutter, (ei) gutter, (ej) gutter, (ek) gutter, (el) gutter, (em) gutter, (en) gutter, (eo) gutter, (ep) gutter, (eq) gutter, (er) gutter, (es) gutter, (et) gutter, (eu) gutter, (ev) gutter, (ew) gutter, (ex) gutter, (ey) gutter, (ez) gutter, (fa) gutter, (fb) gutter, (fc) gutter, (fd) gutter, (fe) gutter, (ff) gutter, (fg) gutter, (fh) gutter, (fi) gutter, (fj) gutter, (fk) gutter, (fl) gutter, (fm) gutter, (fn) gutter, (fo) gutter, (fp) gutter, (fq) gutter, (fr) gutter, (fs) gutter, (ft) gutter, (fu) gutter, (fv) gutter, (fw) gutter, (fx) gutter, (fy) gutter, (fz) gutter, (ga) gutter, (gb) gutter, (gc) gutter, (gd) gutter, (ge) gutter, (gf) gutter, (gg) gutter, (gh) gutter, (gi) gutter, (gj) gutter, (gk) gutter, (gl) gutter, (gm) gutter, (gn) gutter, (go) gutter, (gp) gutter, (gq) gutter, (gr) gutter, (gs) gutter, (gt) gutter, (gu) gutter, (gv) gutter, (gw) gutter, (gx) gutter, (gy) gutter, (gz) gutter, (ha) gutter, (hb) gutter, (hc) gutter, (hd) gutter, (he) gutter, (hf) gutter, (hg) gutter, (hh) gutter, (hi) gutter, (hj) gutter, (hk) gutter, (hl) gutter, (hm) gutter, (hn) gutter, (ho) gutter, (hp) gutter, (hq) gutter, (hr) gutter, (hs) gutter, (ht) gutter, (hu) gutter, (hv) gutter, (hw) gutter, (hx) gutter, (hy) gutter, (hz) gutter, (ia) gutter, (ib) gutter, (ic) gutter, (id) gutter, (ie) gutter, (if) gutter, (ig) gutter, (ih) gutter, (ii) gutter, (ij) gutter, (ik) gutter, (il) gutter, (im) gutter, (in) gutter, (io) gutter, (ip) gutter, (iq) gutter, (ir) gutter, (is) gutter, (it) gutter, (iu) gutter, (iv) gutter, (iw) gutter, (ix) gutter, (iy) gutter, (iz) gutter, (ja) gutter, (jb) gutter, (jc) gutter, (jd) gutter, (je) gutter, (jf) gutter, (jg) gutter, (jh) gutter, (ji) gutter, (jj) gutter, (jk) gutter, (jl) gutter, (jm) gutter, (jn) gutter, (jo) gutter, (jp) gutter, (jq) gutter, (jr) gutter, (js) gutter, (jt) gutter, (ju) gutter, (jv) gutter, (jw) gutter, (jx) gutter, (jy) gutter, (jz) gutter, (ka) gutter, (kb) gutter, (kc) gutter, (kd) gutter, (ke) gutter, (kf) gutter, (kg) gutter, (kh) gutter, (ki) gutter, (kj) gutter, (kk) gutter, (kl) gutter, (km) gutter, (kn) gutter, (ko) gutter, (kp) gutter, (kq) gutter, (kr) gutter, (ks) gutter, (kt) gutter, (ku) gutter, (kv) gutter, (kw) gutter, (kx) gutter, (ky) gutter, (kz) gutter, (la) gutter, (lb) gutter, (lc) gutter, (ld) gutter, (le) gutter, (lf) gutter, (lg) gutter, (lh) gutter, (li) gutter, (lj) gutter, (lk) gutter, (ll) gutter, (lm) gutter, (ln) gutter, (lo) gutter, (lp) gutter, (lq) gutter, (lr) gutter, (ls) gutter, (lt) gutter, (lu) gutter, (lv) gutter, (lw) gutter, (lx) gutter, (ly) gutter, (lz) gutter, (ma) gutter, (mb) gutter, (mc) gutter, (md) gutter, (me) gutter, (mf) gutter, (mg) gutter, (mh) gutter, (mi) gutter, (mj) gutter, (mk) gutter, (ml) gutter, (mm) gutter, (mn) gutter, (mo) gutter, (mp) gutter, (mq) gutter, (mr) gutter, (ms) gutter, (mt) gutter, (mu) gutter, (mv) gutter, (mw) gutter, (mx) gutter, (my) gutter, (mz) gutter, (na) gutter, (nb) gutter, (nc) gutter, (nd) gutter, (ne) gutter, (nf) gutter, (ng) gutter, (nh) gutter, (ni) gutter, (nj) gutter, (nk) gutter, (nl) gutter, (nm) gutter, (nn) gutter, (no) gutter, (np) gutter, (nq) gutter, (nr) gutter, (ns) gutter, (nt) gutter, (nu) gutter, (nv) gutter, (nw) gutter, (nx) gutter, (ny) gutter, (nz) gutter, (oa) gutter, (ob) gutter, (oc) gutter, (od) gutter, (oe) gutter, (of) gutter, (og) gutter, (oh) gutter, (oi) gutter, (oj) gutter, (ok) gutter, (ol) gutter, (om) gutter, (on) gutter, (oo) gutter, (op) gutter, (oq) gutter, (or) gutter, (os) gutter, (ot) gutter, (ou) gutter, (ov) gutter, (ow) gutter, (ox) gutter, (oy) gutter, (oz) gutter, (pa) gutter, (pb) gutter, (pc) gutter, (pd) gutter, (pe) gutter, (pf) gutter, (pg) gutter, (ph) gutter, (pi) gutter, (pj) gutter, (pk) gutter, (pl) gutter, (pm) gutter, (pn) gutter, (po) gutter, (pp) gutter, (pq) gutter, (pr) gutter, (ps) gutter, (pt) gutter, (pu) gutter, (pv) gutter, (pw) gutter, (px) gutter, (py) gutter, (pz) gutter, (qa) gutter, (qb) gutter, (qc) gutter, (qd) gutter, (qe) gutter, (qf) gutter, (qg) gutter, (qh) gutter, (qi) gutter, (qj) gutter, (qk) gutter, (ql) gutter, (qm) gutter, (qn) gutter, (qo) gutter, (qp) gutter, (qq) gutter, (qr) gutter, (qs) gutter, (qt) gutter, (qu) gutter, (qv) gutter, (qw) gutter, (qx) gutter, (qy) gutter, (qz) gutter, (ra) gutter, (rb) gutter, (rc) gutter, (rd) gutter, (re) gutter, (rf) gutter, (rg) gutter, (rh) gutter, (ri) gutter, (rj) gutter, (rk) gutter, (rl) gutter, (rm) gutter, (rn) gutter, (ro) gutter, (rp) gutter, (rq) gutter, (rr) gutter, (rs) gutter, (rt) gutter, (ru) gutter, (rv) gutter, (rw) gutter, (rx) gutter, (ry) gutter, (rz) gutter, (sa) gutter, (sb) gutter, (sc) gutter, (sd) gutter, (se) gutter, (sf) gutter, (sg) gutter, (sh) gutter, (si) gutter, (sj) gutter, (sk) gutter, (sl) gutter, (sm) gutter, (sn) gutter, (so) gutter, (sp) gutter, (sq) gutter, (sr) gutter, (ss) gutter, (st) gutter, (su) gutter, (sv) gutter, (sw) gutter, (sx) gutter, (sy) gutter, (sz) gutter, (ta) gutter, (tb) gutter, (tc) gutter, (td) gutter, (te) gutter, (tf) gutter, (tg) gutter, (th) gutter, (ti) gutter, (tj) gutter, (tk) gutter, (tl) gutter, (tm) gutter, (tn) gutter, (to) gutter, (tp) gutter, (tq) gutter, (tr) gutter, (ts) gutter, (tt) gutter, (tu) gutter, (tv) gutter, (tw) gutter, (tx) gutter, (ty) gutter, (tz) gutter, (ua) gutter, (ub) gutter, (uc) gutter, (ud) gutter, (ue) gutter, (uf) gutter, (ug) gutter, (uh) gutter, (ui) gutter, (uj) gutter, (uk) gutter, (ul) gutter, (um) gutter, (un) gutter, (uo) gutter, (up) gutter, (uq) gutter, (ur) gutter, (us) gutter, (ut) gutter, (uu) gutter, (uv) gutter, (uw) gutter, (ux) gutter, (uy) gutter, (uz) gutter, (va) gutter, (vb) gutter, (vc) gutter, (vd) gutter, (ve) gutter, (vf) gutter, (vg) gutter, (vh) gutter, (vi) gutter, (vj) gutter, (vk) gutter, (vl) gutter, (vm) gutter, (vn) gutter, (vo) gutter, (vp) gutter, (vq) gutter, (vr) gutter, (vs) gutter, (vt) gutter, (vu) gutter, (vv) gutter, (vw) gutter, (vx) gutter, (vy) gutter, (vz) gutter, (wa) gutter, (wb) gutter, (wc) gutter, (wd) gutter, (we) gutter, (wf) gutter, (wg) gutter, (wh) gutter, (wi) gutter, (wj) gutter, (wk) gutter, (wl) gutter, (wm) gutter, (wn) gutter, (wo) gutter, (wp) gutter, (wq) gutter, (wr) gutter, (ws) gutter, (wt) gutter, (wu) gutter, (wv) gutter, (ww) gutter, (wx) gutter, (wy) gutter, (wz) gutter, (xa) gutter, (xb) gutter, (xc) gutter, (xd) gutter, (xe) gutter, (xf) gutter, (xg) gutter, (xh) gutter, (xi) gutter, (xj) gutter, (xk) gutter, (xl) gutter, (xm) gutter, (xn) gutter, (xo) gutter, (xp) gutter, (xq) gutter, (xr) gutter, (xs) gutter, (xt) gutter, (xu) gutter, (xv) gutter, (xw) gutter, (xx) gutter, (xy) gutter, (xz) gutter, (ya) gutter, (yb) gutter, (yc) gutter, (yd) gutter, (ye) gutter, (yf) gutter, (yg) gutter, (yh) gutter, (yi) gutter, (yj) gutter, (yk) gutter, (yl) gutter, (ym) gutter, (yn) gutter, (yo) gutter, (yp) gutter, (yq) gutter, (yr) gutter, (ys) gutter, (yt) gutter, (yu) gutter, (yv) gutter, (yw) gutter, (yx) gutter, (yy) gutter, (yz) gutter, (za) gutter, (zb) gutter, (zc) gutter, (zd) gutter, (ze) gutter, (zf) gutter, (zg) gutter, (zh) gutter, (zi) gutter, (zj) gutter, (zk) gutter, (zl) gutter, (zm) gutter, (zn) gutter, (zo) gutter, (zp) gutter, (zq) gutter, (zr) gutter, (zs) gutter, (zt) gutter, (zu) gutter, (zv) gutter, (zw) gutter, (zx) gutter, (zy) gutter, (zz) gutter.



DEPARTMENT OF ENGINEERING
 CITY OF SAN BERNARDINO
 ARROWHEAD AVENUE
 BETWEEN RIALTO AVENUE AND THIRD STREET

DRAWN BY: [Signature]
 CHECKED BY: [Signature]
 DATE: [Date]

1. All work shown on these plans shall be done in accordance with applicable provisions of Standard Specifications for Highways, published August 1939.

2. Show from top to bottom: (a) grade, (b) curb, (c) gutter, (d) gutter, (e) gutter, (f) gutter, (g) gutter, (h) gutter, (i) gutter, (j) gutter, (k) gutter, (l) gutter, (m) gutter, (n) gutter, (o) gutter, (p) gutter, (q) gutter, (r) gutter, (s) gutter, (t) gutter, (u) gutter, (v) gutter, (w) gutter, (x) gutter, (y) gutter, (z) gutter.

3. The engineer is not responsible for the accuracy of the data furnished by the contractor.

4. The contractor shall be responsible for the accuracy of the data furnished by the contractor.

5. The contractor shall be responsible for the accuracy of the data furnished by the contractor.